

Notice of variation and consolidation with introductory note

The Environmental Permitting (England & Wales) Regulations 2016

Clearaway Recycling Limited

Archers Field
Burnt Mills Industrial Estate
Basildon
Essex
SS13 1DH

Variation application number

EPR/GB3506KE/V004

Permit number

EPR/GB3506KE

Archers Field

Permit number **EPR/GB3506KE**

Introductory note

This introductory note does not form a part of the notice

Under the Environmental Permitting (England & Wales) Regulations 2016 (schedule 5, part 1, paragraph 19) a variation may comprise a consolidated permit reflecting the variations and a notice specifying the variations included in that consolidated permit.

Schedule 1 of the notice specifies the conditions that have been varied and schedule 2 comprises a consolidated permit which reflects the variations being made. All the conditions of the permit have been varied and are subject to the right of appeal.

The current permit allows the site to do the following activities:

- A1 activity – Refuse Derived Fuel (RDF) production.
- A2 activity – Household, commercial and industrial waste transfer station (HCI) of non-hazardous waste only.
- A3 activity - Metal recycling and Waste Electrical and Electronic Equipment (WEEE) authorised treatment facility.

As part of this variation, the site proposed to make the following changes:

- To include a new activity A4 activity – Hazardous waste transfer station and incorporating associated waste codes which are: 17 02 04*, 19 12 06*, 20 01 37*, 17 04 10*, 17 04 11.
- To extend the permitted site boundary.
- To delete waste code 19 02 99.
- To include 17 04 10* waste code under A3 activity.
- Table S1.1 has been amended to include limits on hazardous waste treatment which was previously omitted from the permit.
- The A3 activity name has been amended to read Metal Recycling and Waste Electrical and Electronic Equipment (WEEE) authorised treatment facility.

The annual tonnage is no more than 280,000 tonnes per annum for A1 and A2 activities in aggregate, and 20,250 tonnes per annum for A3 and A4 activities in aggregate. The total annual throughput for all A1, A2, A3 and A4 activities shall be no more than 300,250 tonnes per annum (in aggregate).

The schedules specify the changes made to the permit.

The status log of a permit sets out the permitting history, including any changes to the permit reference number.

Status log of the permit		
Description	Date	Comments
Waste Management Licence EAWML 71311	29/01/04	Original licence issued to G.B.N Services Limited.
Modification of EAWML 71311	20/04/05	Variation to add End-of-life Vehicles (ELV) operation to existing licence.
Modification EAWML 71311	19/06/08	Variation to add additional waste types and update working plan.
Modification of EAWML 71311	01/07/08	Correction to remove referencing to special waste.
Modification of EAWML 71311 EPR/SP3694NW/V004	24/09/10	Variation to add WEEE waste types and associated conditions.

Status log of the permit		
Description	Date	Comments
Variation determined EPR/SP3694NW/V006	25/01/16	Varied and consolidated permit issued in modern format to G.B.N Services Limited.
Transfer determined EPR/GB3506KE/T001 (full transfer of permit EPR/SP3694NW)	29/08/18	Full permit transfer to Clearaway Recycling Limited (EPR/GB3506KE)
Variation determined EPR/GB3506KE/V002	07/08/19	Variation to increase site boundary and update permit into modern format. Varied permit issued to Clearaway Recycling Limited.
Variation determined EPR/GB3506KE/V003	10/01/20	Variation to increase annual tonnage for Waste transfer station activity.
Application EPR/GB3506KE/V004 (variation and consolidation)	Duly made 10/10/24	Application to vary the permit to increase site boundary, to include hazardous waste transfer activity and to update the permit to modern conditions.
Response to email dated 15/10/24	15/10/24	Confirmation received on the following: - To delete 19 02 99 from the permit. - Clarity on WEEE treatment on site. - List of EWC waste codes under A3 activity. - Individual tonnage limits under each activity.
Variation determined and consolidation issued EPR/GB3506KE	13/11/2024	Varied and consolidated permit issued in modern format to Clearaway Recycling Limited

End of introductory note

Notice of variation and consolidation

The Environmental Permitting (England and Wales) Regulations 2016

The Environment Agency in exercise of its powers under regulation 20 of the Environmental Permitting (England and Wales) Regulations 2016 varies

Permit number

EPR/GB3506KE

Issued to

Clearaway Recycling Limited (“the operator”)

whose registered office is

Monometer House

Rectory Grove

Leigh-On-Sea

Essex

SS9 2HN

company registration number 07306316

to operate a regulated facility at

Archers Field

Burnt Mills Industrial Estate

Basildon

Essex

SS13 1DH

to the extent set out in the schedules.

The notice shall take effect from 13/11/2024

Name	Date
Abuoma Ogbuka	13/11/2024

Authorised on behalf of the Environment Agency

Schedule 1

All conditions have been varied by the consolidated permit as a result of the application made by the operator.

Schedule 2 – consolidated permit

Consolidated permit issued as a separate document.

Permit

The Environmental Permitting (England and Wales) Regulations 2016

Permit number

EPR/GB3506KE

This is the consolidated permit referred to in the variation and consolidation notice for application EPR/GB3506KE/V004 authorising,

Clearaway Recycling Limited (“the operator”),

whose registered office is

Monometer House

Rectory Grove

Leigh-On-Sea

Essex

SS9 2HN

company registration number 07306316

to operate waste operations at

Archers Field

Burnt Mills Industrial Estate

Basildon

Essex

SS13 1DH

to the extent authorised by and subject to the conditions of this permit.

Name	Date
Abuoma Ogbuka	13/11/2024

Authorised on behalf of the Environment Agency

Conditions

1 Management

1.1 General management

- 1.1.1 The operator shall manage and operate the activities:
- (a) in accordance with a written management system that identifies and minimises risks of pollution, including those arising from operations, maintenance, accidents, incidents, non-conformances, closure and those drawn to the attention of the operator as a result of complaints; and
 - (b) using sufficient competent persons and resources.
- 1.1.2 Records demonstrating compliance with condition 1.1.1 shall be maintained.
- 1.1.3 Any person having duties that are or may be affected by the matters set out in this permit shall have convenient access to a copy of it kept at or near the place where those duties are carried out.
- 1.1.4 The operator shall comply with the requirements of an approved competence scheme.

1.2 Avoidance, recovery and disposal of wastes produced by the activities

- 1.2.1 The operator shall take appropriate measures to ensure that:
- (a) the waste hierarchy referred to in Article 4 of the Waste Framework Directive is applied to the generation of waste by the activities; and
 - (b) any waste generated by the activities is treated in accordance with the waste hierarchy referred to in Article 4 of the Waste Framework Directive; and
 - (c) where disposal is necessary, this is undertaken in a manner which minimises its impact on the environment.
- 1.2.2 The operator shall review and record at least every four years whether changes to those measures should be made and take any further appropriate measures identified by a review.

2 Operations

2.1 Permitted activities

- 2.1.1 The operator is only authorised to carry out the activities specified in schedule 1 table S1.1 (the “activities”).

2.2 The site

- 2.2.1 The activities shall not extend beyond the site, being the land shown edged in green on the site plan at schedule 7 to this permit.

2.3 Operating techniques

- 2.3.1 The activities shall, subject to the conditions of this permit, be operated using the techniques and in the manner described in the documentation specified in schedule 1, table S1.2, unless otherwise agreed in writing by the Environment Agency.

- 2.3.2 If notified by the Environment Agency that the activities are giving rise to pollution, the operator shall submit to the Environment Agency for approval within the period specified, a revision of any plan or other documentation ("plan") specified in schedule 1, table S1.2 or otherwise required under this permit which identifies and minimises the risks of pollution relevant to that plan, and shall implement the approved revised plan in place of the original from the date of approval, unless otherwise agreed in writing by the Environment Agency.
- 2.3.3 Waste shall only be accepted if:
- (a) it is of a type and quantity listed in schedule 2 tables S2.1 or S2.2 or S2.3 or S2.4; and
 - (b) it conforms to the description in the documentation supplied by the producer and holder.

2.4 Technical requirements

Hazardous waste storage and treatment

- 2.4.1 Hazardous waste shall not be mixed, either with a different category of hazardous waste or with other waste, substances or materials, unless it is authorised by schedule 1 table S1.1 and appropriate measures are taken.

2.5 WEEE storage and treatment

- 2.5.1 Spillage collection facilities and, where appropriate, decanters and cleanser-degreasers shall be provided and used as necessary.
- 2.5.2 WEEE (disassembled spare parts, components and residues) shall be stored in areas provided with a weatherproof covering where appropriate or in containers providing a weatherproof covering where appropriate.
- 2.5.3 WEEE shall be treated using best available treatment, recovery and recycling techniques (BATRRRT).
- 2.5.4 All fluids contained within any WEEE shall be removed prior to further treatment.
- 2.5.5 As a minimum, the substances, preparations and components specified in table S1.3 shall be removed from any separately collected WEEE unless the WEEE is being prepared for re-use or the operator has taken appropriate measures to ensure their removal following transfer off site.
- 2.5.6 Separately collected components of WEEE specified in table S1.4 shall be treated in accordance with the methods specified in that table unless the WEEE is being prepared for re-use or the operator has taken appropriate measures to ensure their removal following transfer off site.
- 2.5.7 Any liquids including those in disassembled spare parts, batteries, capacitors containing PCBs/PCTs and any other hazardous waste shall be stored in suitable sealed and labelled containers.
- 2.5.8 Equipment shall be provided and used to record the weight of untreated WEEE accepted at, and components and materials leaving the site.

3 Emissions and monitoring

3.1 Emissions of substances not controlled by emission limits

- 3.1.1 Emissions of substances not controlled by emission limits (excluding odour) shall not cause pollution. The operator shall not be taken to have breached this condition if appropriate measures, including, but not limited to, those specified in any approved emissions management plan, have been taken to prevent or where that is not practicable, to minimise, those emissions.

- 3.1.2 All liquids in containers, whose emission to water or land could cause pollution, shall be provided with secondary containment, unless the operator has used other appropriate measures to prevent or where that is not practicable, to minimise, leakage and spillage from the primary container.

3.2 Odour

- 3.2.1 Emissions from the activities shall be free from odour at levels likely to cause pollution outside the site, as perceived by an authorised officer of the Environment Agency, unless the operator has used appropriate measures, including, but not limited to, those specified in any approved odour management plan, to prevent or where that is not practicable to minimise the odour.

- 3.2.2 The operator shall:

- (a) if notified by the Environment Agency that the activities are giving rise to pollution outside the site due to odour, submit to the Environment Agency for approval within the period specified, an odour management plan which identifies and minimises the risks of pollution from odour;
- (b) implement the approved odour management plan, from the date of approval, unless otherwise agreed in writing by the Environment Agency.

3.3 Noise and vibration

- 3.3.1 Emissions from the activities shall be free from noise and vibration at levels likely to cause pollution outside the site, as perceived by an authorised officer of the Environment Agency, unless the operator has used appropriate measures, including, but not limited to, those specified in any approved noise and vibration management plan to prevent or where that is not practicable to minimise the noise and vibration.

- 3.3.2 Emissions from the metal shredder shall be free from sudden noise or vibration at levels likely to cause pollution outside the site, unless the operator has used appropriate measures, including but not limited to, those specified in any approved noise and vibration management plan to prevent or where that is not practicable to minimise the sudden noise and vibration.

- 3.3.3 The operator shall:

- (a) if notified by the Environment Agency that the activities are giving rise to pollution outside the site due to noise and vibration, submit to the Environment Agency for approval within the period specified, a noise and vibration management plan which identifies and minimises the risks of pollution from noise and vibration;
- (b) implement the approved noise and vibration management plan, from the date of approval, unless otherwise agreed in writing by the Environment Agency.

3.4 Pests

- 3.4.1 The activities shall not give rise to the presence of pests which are likely to cause pollution, hazard or annoyance outside the boundary of the site. The operator shall not be taken to have breached this condition if appropriate measures, including, but not limited to, those specified in any approved pests management plan, have been taken to prevent or where that is not practicable, to minimise the presence of pests on the site.

- 3.4.2 The operator shall:

- (a) if notified by the Environment Agency, submit to the Environment Agency for approval within the period specified, a pests management plan which identifies and minimises risks of pollution, hazard or annoyance from pests;
- (b) implement the pests management plan, from the date of approval, unless otherwise agreed in writing by the Environment Agency.

3.5 Fire prevention

3.5.1 The operator shall take all appropriate measures to prevent fires on site and minimise the risk of pollution from them including, but not limited to, those specified in any approved fire prevention plan.

3.6 Records

3.6.1 All records required to be made by this permit shall:

- (a) be legible;
- (b) be made as soon as reasonably practicable;
- (c) if amended, be amended in such a way that the original and any subsequent amendments remain legible, or are capable of retrieval; and
- (d) be retained, unless otherwise agreed in writing by the Environment Agency, for at least 6 years from the date when the records were made,
 - (i) off-site environmental effects; and
 - (ii) matters which affect the condition of the land and groundwater.

3.6.2 The operator shall keep on site all records, plans and the management system required to be maintained by this permit, unless otherwise agreed in writing by the Environment Agency.

3.7 Reporting

3.7.1 The operator shall send all reports and notifications required by the permit to the Environment Agency using the contact details supplied in writing by the Environment Agency.

3.7.2 Within one month of the end of each quarter, the operator shall submit to the Environment Agency using the form made available for the purpose, the information specified on the form relating to the site and the waste accepted and removed from it during the previous quarter.

3.8 Notifications

3.8.1 The Environment Agency shall be notified without delay following the detection of:

- (a) any malfunction, breakdown or failure of equipment or techniques, accident, or emission of a substance not controlled by an emission limit which has caused, is causing or may cause significant pollution;
- (b) the breach of a limit specified in the permit; or
- (c) any significant adverse environmental effects.

3.8.2 Any information provided under condition 4.3.1 shall be confirmed by sending the information listed in schedule 5 to this permit within the time period specified in that schedule.

3.8.3 Where the Environment Agency has requested in writing that it shall be notified when the operator is to undertake monitoring and/or spot sampling, the operator shall inform the Environment Agency when the relevant monitoring and/or spot sampling is to take place. The operator shall provide this information to the Environment Agency at least 14 days before the date the monitoring is to be undertaken.

3.8.4 The Environment Agency shall be notified within 14 days of the occurrence of the following matters, except where such disclosure is prohibited by Stock Exchange rules:

Where the operator is a registered company:

- (a) any change in the operator's trading name, registered name or registered office address; and

- (b) any steps taken with a view to the operator going into administration, entering into a company voluntary arrangement or being wound up.

Where the operator is a corporate body other than a registered company:

- (a) any change in the operator's name or address; and
- (b) any steps taken with a view to the dissolution of the operator.

In any other case:

- (a) the death of any of the named operators (where the operator consists of more than one named individual);
- (b) any change in the operator's name(s) or address(es); and
- (c) any steps taken with a view to the operator, or any one of them, going into bankruptcy, entering into a composition or arrangement with creditors, or, in the case of them being in a partnership, dissolving the partnership.

3.8.5 Where the operator proposes to make a change in the nature or functioning, or an extension of the activities, which may have consequences for the environment and the change is not otherwise the subject of an application for approval under the Regulations or this permit:

- (a) the Environment Agency shall be notified at least 14 days before making the change; and
- (b) the notification shall contain a description of the proposed change in operation.

3.9 Interpretation

3.9.1 In this permit the expressions listed in schedule 6 shall have the meaning given in that schedule.

3.9.2 In this permit references to reports and notifications mean written reports and notifications, except where reference is made to notification being made "without delay", in which case it may be provided by telephone.

Schedule 1 – Operations

Table S1.1 activities	
Description of activities for waste operations	Limits of activities
<p><u>A1 – Non-hazardous waste transfer station</u></p> <p>R3: Recycling/reclamation of organic substances which are not used as solvents (including composting and other biological transformation processes)</p> <p>R4: Recycling/reclamation of metals and metal compounds</p> <p>R5: Recycling/reclamation of other inorganic materials</p> <p>R13: Storage of waste pending any of the operations numbered R1 to R12 (excluding temporary storage, pending collection, on the site where the waste is produced)</p> <p>D9: Physico-chemical treatment not specified elsewhere which results in final compounds or mixtures which are discarded by means of any of the operations numbered D1 to D12</p> <p>D14: Repacking prior to submission to any of the operations numbered D1 to D13</p> <p>D15: Storage pending any of the operations numbered D1 to D14 (excluding temporary storage, pending collection, on the site where the waste is produced)</p>	<p>Physical treatment including manual sorting, separation, screening, baling, shredding, crushing or compaction of non-hazardous waste (in aggregate) into different components for disposal (no more than 50 tonnes per day) or recovery.</p> <p>Treatment does not include soil or aggregate washing or heat treatments.</p> <p>No more than a total of 50 tonnes (in aggregate) of intact and shredded waste vehicle tyres (waste codes 16 01 03 and 19 12 04) shall be stored at the site.</p> <p>All waste must be stored and transferred on an impermeable surface with sealed drainage system.</p> <p>All waste treatment must be carried out on an impermeable surface with sealed drainage system.</p> <p>Subject to any other requirements of this permit non-hazardous wastes shall be stored for no longer than 3 years prior to recovery.</p> <p>Waste types as specified in Table S2.1.</p>
<p><u>A2 - Refuse Derived Fuel (RDF) production</u></p> <p>R3: Recycling/reclamation of organic substances which are not used as solvents (including composting and other biological transformation processes)</p> <p>R4: Recycling/reclamation of metals and metal compounds</p> <p>R5: Recycling/reclamation of other inorganic materials</p>	<p>Physical treatment including manual sorting/separation, baling and wrapping of non-hazardous waste for recovery.</p> <p>All waste must be stored and transferred on an impermeable surface with sealed drainage system.</p> <p>All waste treatment must be carried out on an impermeable surface with sealed drainage system.</p> <p>Subject to any other requirements of this permit non-hazardous wastes shall be stored for no longer than 3 years prior to recovery.</p>

Table S1.1 activities	
Description of activities for waste operations	Limits of activities
R13: Storage of waste pending any of the operations numbered R1 to R12 (excluding temporary storage, pending collection, on the site where the waste is produced)	Waste types as specified in Table S2.2.
<p><u>A3 - Metal recycling and Waste Electrical and Electronic Equipment (WEEE) authorised treatment facility</u></p> <p>R3: Recycling/ reclamation of organic substances which are not used as solvents</p> <p>R4: Recycling/ reclamation of metals and metal compounds</p> <p>R5: Recycling/ reclamation of other inorganic compounds</p> <p>R13: Storage of waste pending any of the operations numbered R1 to R12 (excluding temporary storage, pending collection, on the site where it is produced)</p>	<p>Treatment consisting only of sorting, separation, grading, shearing, shredding, baling, compaction, crushing, granulation or cutting of waste into different components for recovery.</p> <p>Treatment in shredders of metal waste for recovery shall be no more than 75 tonnes per day (in aggregate).</p> <p>No more than 10 tonnes per day (in aggregate) of hazardous waste to be treated at the site.</p> <p>The maximum quantity of hazardous waste (in aggregate) that can be accepted or stored at the site shall not exceed 50 tonnes at any one time.</p> <p>There shall be no treatment of batteries, other than sorting and separating from other wastes, and repackaging for third party processing.</p> <p>Lead acid batteries shall be stored upright in containers with the electrical connectors pointing upwards. The containers shall be impermeable with an acid resistant base and, unless stored under weatherproof covering, a lid to prevent ingress of water.</p> <p>Other batteries and accumulators shall be stored under weatherproof covering or in suitable containers. Batteries of different types and chemistry shall be stored separately. All waste must be stored and transferred on an impermeable surface with sealed drainage system.</p> <p>All WEEE treatment must be carried out within a building on an impermeable surface with sealed drainage system.</p> <p>All other waste treatment must be carried out on an impermeable surface with sealed drainage system.</p>

Table S1.1 activities	
Description of activities for waste operations	Limits of activities
	<p>Buildings, covered areas or containers shall meet the following requirements:</p> <ul style="list-style-type: none"> ○ buildings, covered areas shall be designed, constructed and maintained to prevent ingress of rain and surface water; including impermeable surface with sealed drainage system. ○ rain and uncontaminated surface water shall be kept separate from contaminated water and other liquids. ○ containers containing waste shall be stored on an impermeable surface with sealed drainage system. <p>Hazardous wastes shall be stored for no longer than 6 months.</p> <p>Subject to any other requirements of this permit non-hazardous wastes shall be stored for no longer than 3 years prior to recovery.</p> <p>Waste types suitable for acceptance are limited to those specified in Table S2.3.</p>
<p><u>A4: Hazardous waste transfer station</u></p> <p>D15: Storage pending any of the operations numbered D1 to D14 (excluding temporary storage, pending collection, on the site where the waste is produced)</p>	<p>There shall be no treatment of hazardous waste under A4 activity.</p> <p>The maximum quantity of hazardous waste, in aggregate, that can be stored at the site shall not exceed 50 tonnes at any one time.</p> <p>All waste storage and transferred must be carried out within a building on an impermeable surface with sealed drainage system.</p> <p>Buildings, covered areas or containers shall meet the following requirements:</p> <ul style="list-style-type: none"> ○ buildings, covered areas shall be designed, constructed and maintained to prevent ingress of rain and surface water; including impermeable surface with sealed drainage system. ○ rain and uncontaminated surface water shall be kept separate from contaminated water and other liquids. ○ containers containing waste shall be stored on an impermeable surface with sealed drainage system. <p>Hazardous wastes shall be stored for no longer than 6 months.</p> <p>Waste types suitable for acceptance are limited to those specified in Table S2.4.</p>

Table S1.2 Operating techniques		
Description	Parts	Date Received
Response to schedule 5 Notice dated 17/12/2015	Approved Fire Prevention Plan version 3.2	12/01/16
Non-hazardous and inert waste: appropriate measures for permitted facilities. Published 12th July 2021 Updated: 1 August 202	All relevant parts of the appropriate measures guidance shall apply.	10/10/24
Chemical waste: appropriate measures for permitted facilities. Published 18 November 2020 Updated: 18 th November 2020	All relevant parts of the appropriate measures guidance shall apply.	10/10/24
Waste electrical and electronic equipment (WEEE): appropriate measures for permitted facilities. Published 13 July 2022 Updated: 13 July 2022	All relevant parts of the appropriate measures guidance shall apply.	10/10/24

Table S1.3 Substances, preparations and components to be removed from separately collected WEEE

- Capacitors containing polychlorinated biphenyls in accordance with Council Directive 96/59/EC of 16 September 1996 on the disposal of polychlorinated biphenyls and polychlorinated terphenyls (PCB/PCT)
- Mercury-containing components, such as switches or backlighting lamps
- Batteries
- Printed circuit boards of mobile phones generally, and of other devices if the surface of the printed circuit board is greater than 10 square centimetres
- Toner cartridges, liquid and paste, as well as colour toner
- Plastic containing brominated flame retardants
- Asbestos waste and components which contain asbestos
- Cathode ray tubes
- Chlorofluorocarbons (CFC), hydrochlorofluorocarbons (HCFC), hydrofluorocarbons (HFC), or hydrocarbons (HC)
- Gas discharge lamps
- Liquid crystal displays (together with their casing where appropriate) of a surface greater than 100 square centimetres and all those back-lighted with gas discharge lamps
- External electric cables
- Components containing refractory ceramic fibres as described in REGULATION (EC) No 1272/2008 OF THE EUROPEAN PARLIAMENT AND OF THE COUNCIL of 16 December 2008 on classification, labelling and packaging of substances and mixtures, amending and repealing Directives 67/548/EEC and 1999/45/EC, and amending Regulation (EC) No 1907/2006.
- Components containing radioactive substances with the exception of components that are below the exemption thresholds set in Article 3 of and the Annex I to Council Directive 96/29/Euratom of 13 May 1996 laying down basic safety standards for the protection of the health of workers and the general public against the dangers arising from ionising radiation
- Electrolyte capacitors containing “substances of concern” (height > 25mm, diameter > 25mm or proportionately similar volume)

Schedule 2 – Waste types

Table S2.1 Permitted waste types and quantities for A1 – Non-hazardous waste transfer station.	
Maximum quantity	The total quantity of waste accepted at this site for A1 and A2 activities shall be no more than 280,000 tonnes a year.
Waste code	Description
Exclusions	Wastes having any of the following characteristics shall not be accepted: <ul style="list-style-type: none"> • Consisting solely or mainly of dusts, powders or loose fibres
01	Wastes resulting from exploration, mining, quarrying, and physical and chemical treatment of minerals
01 04	wastes from physical and chemical processing of non-metalliferous minerals
01 04 08	waste gravel and crushed rocks other than those mentioned in 01 04 07
01 04 09	waste sand and clays
01 04 13	wastes from stone cutting and sawing other than those mentioned in 01 04 07
02	Wastes from agriculture, horticulture, aquaculture, forestry, hunting and fishing, food preparation and processing
02 01	wastes from agriculture, horticulture, aquaculture, forestry, hunting and fishing
02 01 04	waste plastics (except packaging)
03	Wastes from wood processing and the production of panels and furniture, pulp, paper and cardboard
03 01	wastes from wood processing and the production of panels and furniture
03 01 05	sawdust, shavings, cuttings, wood, particle board and veneer other than those mentioned in 03 01 04
15	Waste packaging, absorbents, wiping cloths, filter materials and protective clothing not otherwise specified
15 01	packaging (including separately collected municipal packaging waste)
15 01 01	paper and cardboard packaging
15 01 02	plastic packaging
15 01 03	wooden packaging
15 01 04	metallic packaging
15 01 05	composite packaging
15 01 07	glass packaging
15 01 09	textile packaging
16	Wastes not otherwise specified in the list
16 01	end-of-life vehicles from different means of transport (including off-road machinery) and wastes from dismantling of end-of-life vehicles and vehicle maintenance (except 13, 14, 16 06 and 16 08)
16 01 03	end-of-life tyres
17	Construction and demolition wastes (including excavated soil from contaminated sites)
17 01	concrete, bricks, tiles and ceramics
17 01 01	concrete

Table S2.1 Permitted waste types and quantities for A1 – Non-hazardous waste transfer station.	
Maximum quantity	The total quantity of waste accepted at this site for A1 and A2 activities shall be no more than 280,000 tonnes a year.
Waste code	Description
17 01 02	bricks
17 01 03	tiles and ceramics
17 01 07	mixtures of concrete, bricks, tiles and ceramics other than those mentioned in 17 01 06
17 02	wood, glass and plastic
17 02 01	wood
17 02 02	glass
17 02 03	plastic
17 03	bituminous mixtures, coal tar and tarred products
17 03 02	bituminous mixtures other than those mentioned in 17 03 01
17 05	soil (including excavated soil from contaminated sites), stones and dredging spoil
17 05 04	soil and stones other than those mentioned in 17 05 03
17 05 08	track ballast other than those mentioned in 17 05 07
17 06	insulation materials and asbestos-containing construction materials
17 06 04	insulation materials other than those mentioned in 17 06 01 and 17 06 03
17 08	gypsum-based construction material
17 08 02	gypsum-based construction materials other than those mentioned in 17 08 01
17 09	other construction and demolition wastes
17 09 04	mixed construction and demolition wastes other than those mentioned in 17 09 01, 17 09 02 and 17 09 03
19	Wastes from waste management facilities, off-site waste water treatment plants and the preparation of water intended for human consumption and water for industrial use
19 02	wastes from physico/chemical treatments of waste (including dechromatation, decyanidation, neutralisation)
19 02 03	premixed wastes composed only of non-hazardous wastes
19 10	wastes from shredding of metal-containing wastes
19 10 01	iron and steel waste
19 12	wastes from the mechanical treatment of waste (for example sorting, crushing, compacting, pelletising) not otherwise specified
19 12 01	paper and cardboard
19 12 04	plastic and rubber
19 12 05	glass
19 12 07	wood other than that mentioned in 19 12 06
19 12 08	textiles
19 12 09	minerals (for example sand, stones)
19 12 10	combustible waste (refuse derived fuel)

Table S2.1 Permitted waste types and quantities for A1 – Non-hazardous waste transfer station.	
Maximum quantity	The total quantity of waste accepted at this site for A1 and A2 activities shall be no more than 280,000 tonnes a year.
Waste code	Description
19 12 12	other wastes (including mixtures of materials) from mechanical treatment of wastes other than those mentioned in 19 12 11
19 13	wastes from soil and groundwater remediation
19 13 02	solid wastes from soil remediation other than those mentioned in 19 13 01
20	Municipal wastes (household waste and similar commercial, industrial and institutional wastes) including separately collected fractions
20 01	separately collected fractions (except 15 01)
20 01 01	paper and cardboard
20 01 02	glass
20 01 10	clothes
20 01 11	textiles
20 01 38	wood other than that mentioned in 20 01 37
20 01 39	plastics
20 02	garden and park wastes (including cemetery waste)
20 02 01	biodegradable waste
20 02 02	soil and stones
20 03	other municipal wastes
20 03 01	mixed municipal waste
20 03 02	waste from markets
20 03 07	bulky waste

Table S2.2 Permitted waste types and quantities for A2 - Refuse Derived Fuel (RDF) production.	
Maximum quantity	The total quantity of waste accepted at this site for A1 and A2 activities shall be no more than 280,000 tonnes a year.
Waste code	Description
15	Waste packaging, absorbents, wiping cloths, filter materials and protective clothing not otherwise specified
15 01	packaging (including separately collected municipal packaging waste)
15 01 01	paper and cardboard packaging
15 01 02	plastic packaging
15 01 03	wooden packaging
15 01 05	composite packaging
15 01 07	glass packaging
15 01 09	textile packaging
19 12	wastes from the mechanical treatment of waste (for example sorting, crushing, compacting, pelletising) not otherwise specified
19 12 01	paper and cardboard
19 12 04	plastic and rubber
19 12 07	wood other than that mentioned in 19 12 06
19 12 08	textiles
19 12 10	combustible waste (refuse derived fuel)
19 12 12	other wastes (including mixtures of materials) from mechanical treatment of wastes other than those mentioned in 19 12 11
20	Municipal wastes (household waste and similar commercial, industrial and institutional wastes) including separately collected fractions
20 01	separately collected fractions (except 15 01)
20 01 01	paper and cardboard
20 01 10	clothes
20 01 11	textiles
20 01 38	wood other than that mentioned in 20 01 37
20 01 39	plastics
20 03	other municipal wastes
20 03 01	mixed municipal waste
20 03 07	bulky waste

Table S2.3 Permitted waste types and quantities for A3 - Metal recycling and Waste Electrical and Electronic Equipment (WEEE) authorised treatment facility.	
Maximum quantity	The total quantity of waste accepted at the site for the A3 and A4 activities shall be no more than 20,250 tonnes a year.
Exclusions:	Wastes having any of the following characteristics shall not be accepted: <ul style="list-style-type: none"> • Consisting solely or mainly of dusts, powders or loose fibres • Containing ozone-depleting substances
Waste code	Description
02	Wastes from agriculture, horticulture, aquaculture, forestry, hunting and fishing, food preparation and processing
02 01	wastes from agriculture, horticulture, aquaculture, forestry, hunting and fishing
02 01 10	waste metal
09	Wastes from the photographic industry
09 01	wastes from the photographic industry
09 01 11*	single-use cameras containing batteries included in 16 06 01, 16 06 02 or 16 06 03
15	Waste packaging, absorbents, wiping cloths, filter materials and protective clothing not otherwise specified
15 01	packaging (including separately collected municipal packaging waste)
15 01 04	metallic packaging
15 01 06	mixed packaging
16	Wastes not otherwise specified in the list
16 02	wastes from electrical and electronic equipment
16 02 10*	discarded equipment containing or contaminated by PCBs other than those mentioned in 16 02 09
16 02 13*	discarded equipment containing hazardous components other than those mentioned in 16 02 09 to 16 02 12
16 02 14	discarded equipment other than those mentioned in 16 02 09 to 16 02 13
16 02 15*	hazardous components removed from discarded equipment
16 02 16	components removed from discarded equipment other than those mentioned in 16 02 15
16 06	batteries and accumulators
16 06 01*	lead batteries
16 06 02*	Ni-Cd batteries
16 06 03*	mercury-containing batteries
16 06 04	alkaline batteries (except 16 06 03)
16 06 05	other batteries and accumulators
17	Construction and demolition wastes (including excavated soil from contaminated sites)
17 04	metals (including their alloys)
17 04 01	copper, bronze, brass
17 04 02	aluminium
17 04 03	lead
17 04 04	zinc

Table S2.3 Permitted waste types and quantities for A3 - Metal recycling and Waste Electrical and Electronic Equipment (WEEE) authorised treatment facility.	
Maximum quantity	The total quantity of waste accepted at the site for the A3 and A4 activities shall be no more than 20,250 tonnes a year.
Exclusions:	Wastes having any of the following characteristics shall not be accepted: <ul style="list-style-type: none"> • Consisting solely or mainly of dusts, powders or loose fibres • Containing ozone-depleting substances
Waste code	Description
17 04 05	iron and steel
17 04 06	tin
17 04 07	mixed metals
17 04 10*	cables containing oil, coal tar and other hazardous substances from construction and demolition waste sources
17 04 11	cables other than those mentioned in 17 04 10
19	Wastes from waste management facilities, off-site waste water treatment plants and the preparation of water intended for human consumption and water for industrial use
19 12	wastes from the mechanical treatment of waste (for example sorting, crushing, compacting, pelletising) not otherwise specified
19 12 01	paper and cardboard
19 12 03	non-ferrous metal
20	Municipal wastes (household waste and similar commercial, industrial and institutional wastes) including separately collected fractions
20 01	separately collected fractions (except 15 01)
20 01 21*	fluorescent tubes and other mercury-containing waste
20 01 34	batteries and accumulators other than those mentioned in 20 01 33
20 01 35*	discarded electrical and electronic equipment other than those mentioned in 20 01 21 and 20 01 23 containing hazardous components
20 01 36	discarded electrical and electronic equipment other than those mentioned in 20 01 21, 20 01 23 and 20 01 35
20 01 40	metals

Table S2.4 Permitted waste types and quantities for A4 - Hazardous waste transfer station.	
Maximum quantity	The total quantity of waste accepted at the site for the A3 and A4 activities shall be no more than 20,250 tonnes a year.
Waste code	Description
17	Construction and demolition wastes (including excavated soil from contaminated sites)
17 02	wood, glass and plastic
17 02 04*	wood containing or contaminated with hazardous substances
17 04	metals (including their alloys)
17 04 10*	cables containing oil, coal tar and other hazardous substances from construction and demolition waste sources
17 04 11	cables other than those mentioned in 17 04 10
19	Wastes from waste management facilities, off-site waste water treatment plants and the preparation of water intended for human consumption and water for industrial use
19 12	wastes from the mechanical treatment of waste (for example sorting, crushing, compacting, pelletising) not otherwise specified
19 12 06*	wood containing hazardous substances
20	Municipal wastes (household waste and similar commercial, industrial and institutional wastes) including separately collected fractions
20 01	separately collected fractions (except 15 01)
20 01 37*	wood containing hazardous substances

Schedule 3 – Emissions and monitoring

There are no emission limits or associated monitoring requirements.

Schedule 4 – Reporting

There is no reporting under this schedule.

Schedule 5 – Notification

These pages outline the information that the operator must provide.

Units of measurement used in information supplied under Part A and B requirements shall be appropriate to the circumstances of the emission. Where appropriate, a comparison should be made of actual emissions and authorised emission limits.

If any information is considered commercially confidential, it should be separated from non-confidential information, supplied on a separate sheet and accompanied by an application for commercial confidentiality under the provisions of the EP Regulations.

Part A

Permit Number	
Name of operator	
Location of Facility	
Time and date of the detection	

(a) Notification requirements for any malfunction, breakdown or failure of equipment or techniques, accident, or emission of a substance not controlled by an emission limit which has caused, is causing or may cause significant pollution

To be notified within 24 hours of detection

Date and time of the event	
Reference or description of the location of the event	
Description of where any release into the environment took place	
Substances(s) potentially released	
Best estimate of the quantity or rate of release of substances	
Measures taken, or intended to be taken, to stop any emission	
Description of the failure or accident.	

(b) Notification requirements for the breach of a limit

To be notified within 24 hours of detection unless otherwise specified below

Emission point reference/ source	
Parameter(s)	
Limit	
Measured value and uncertainty	
Date and time of monitoring	

(b) Notification requirements for the breach of a limit	
To be notified within 24 hours of detection unless otherwise specified below	
Measures taken, or intended to be taken, to stop the emission	

Time periods for notification following detection of a breach of a limit	
Parameter	Notification period

(c) Notification requirements for the detection of any significant adverse environmental effect	
To be notified within 24 hours of detection	
Description of where the effect on the environment was detected	
Substances(s) detected	
Concentrations of substances detected	
Date of monitoring/sampling	

Part B – to be submitted as soon as practicable

Any more accurate information on the matters for notification under Part A.	
Measures taken, or intended to be taken, to prevent a recurrence of the incident	
Measures taken, or intended to be taken, to rectify, limit or prevent any pollution of the environment which has been or may be caused by the emission	
The dates of any unauthorised emissions from the facility in the preceding 24 months.	

Name*	
Post	
Signature	
Date	

* authorised to sign on behalf of the operator

Schedule 6 – Interpretation

“accident” means an accident that may result in pollution.

“Annex I” means Annex I to the Waste Framework Directive.

“Annex II” means Annex II to the Waste Framework Directive.

“application” means the application for this permit, together with any additional information supplied by the operator as part of the application and any response to a notice served under Schedule 5 to the EP Regulations.

“authorised officer” means any person authorised by the Environment Agency under section 108(1) of The Environment Act 1995 to exercise, in accordance with the terms of any such authorisation, any power specified in section 108(4) of that Act.

“building” means a construction that has the objective of providing sheltering cover and minimising emissions of noise, particulate matter, odour and litter.

“controlled substances” means chlorofluorocarbons, other fully halogenated chlorofluorocarbons, halons, carbon tetrachloride, 1,1,1-trichloroethane, methyl bromide, hydrobromofluorocarbons and hydrochlorofluorocarbons listed in Annex I of Regulation (EC) No 2037/2000 of the European Parliament and of the Council of 29 June 2000 on substances that deplete the ozone layer, including their isomers, whether alone or in a mixture, and whether they are virgin, recovered, recycled or reclaimed. This definition shall not cover any controlled substance which is in a manufactured product other than a container used for the transportation or storage of that substance, or insignificant quantities of any controlled substance, originating from inadvertent or coincidental production during a manufacturing process, from unreacted feedstock, or from use as a processing agent which is present in chemical substances as trace impurities, or that is emitted during product manufacture or handling.

“D” means a disposal operation provided for in Annex I to the Waste Framework Directive.

“emissions of substances not controlled by emission limits” means emissions of substances to air, water or land from the activities, either from the emission points specified in schedule 3 or from other localised or diffuse sources, which are not controlled by an emission limit.

“EP Regulations” means The Environmental Permitting (England and Wales) Regulations SI 2016 No.1154 and words and expressions used in this permit which are also used in the Regulations have the same meanings as in those Regulations.

“groundwater” means all water, which is below the surface of the ground in the saturation zone and in direct contact with the ground or subsoil.

“Hazardous property” has the meaning in Annex III of the Waste Framework Directive.

“Hazardous waste” has the meaning given in the Hazardous Waste (England and Wales) Regulations 2005.

“List of Wastes” means the list of wastes established by Commission Decision 2000/532/EC replacing Decision 94/3/EC establishing a list of wastes pursuant to Article 1(a) of Council Directive 75/442/EEC on waste and Council Decision 94/904/EC establishing a list of hazardous waste pursuant to Article 1(4) of Council Directive 91/689/EEC on hazardous waste.

“ozone-depleting substances” “ODS” means “controlled substances” contained in refrigeration, air-conditioning and heat pump equipment, equipment containing solvents, fire protection systems and fire extinguishers.

“pests” means birds, vermin and insects.

“quarter” means a calendar year quarter commencing on 1 January, 1 April, 1 July or 1 October.

“R” means a recovery operation provided for in Annex II to the Waste Framework Directive.

“sealed drainage system” in relation to an impermeable surface, means a drainage system with impermeable components which does not leak and which will ensure that:

- no liquids will run off the surface otherwise than via the system

- all liquids entering the system are collected in a sealed sump, except where liquids may be lawfully discharged.

“Waste code” means the six digit code referable to a type of waste in accordance with the List of Wastes and in relation to hazardous waste, includes the asterisk.

“Waste Framework Directive” or “WFD” means Waste Framework Directive 2008/98/EC of the European Parliament and of the Council on waste, as read in accordance with Schedule 1A to the Environmental Permitting (England and Wales) Regulations 2016.

“year” means calendar year ending 31 December.

When the following terms appear in the waste code list in Schedule 2, table S2.1, or S2.2 or S2.3 or S2.4 for that those tables, they have the meaning given below:

“hazardous substance” means a substance classified as hazardous as a consequence of fulfilling the criteria laid down in parts 2 to 5 of Annex I to Regulation (EC) No 1272/2008.

“heavy metal” means any compound of antimony, arsenic, cadmium, chromium (VI), copper, lead, mercury, nickel, selenium, tellurium, thallium and tin, as well as these materials in metallic form, as far as these are classified as hazardous substances.

“PCBs” means

- polychlorinated biphenyls
- polychlorinated terphenyls
- monomethyl-tetrachlorodiphenyl methane, Monomethyl-dichloro-diphenyl methane, Monomethyldibromo-diphenyl methane
- any mixture containing any of the above mentioned substances in a total of more than 0,005 %by weight.

“transition metals” means any of the following metals: any compound of scandium, vanadium, manganese, cobalt, copper, yttrium, niobium, hafnium, tungsten, titanium, chromium, iron, nickel, zinc, zirconium, molybdenum and tantalum, as well as these materials in metallic form, as far as these are classified as hazardous substances.

“stabilisation” means processes which change the hazardousness of the constituents in the waste and transform hazardous waste into non-hazardous waste.

“solidification” means processes which only change the physical state of the waste by using additives without changing the chemical properties of the waste.

“partly stabilised wastes” means wastes containing, after the stabilisation process, hazardous constituents which have not been changed completely into non-hazardous constituents and could be released into the environment in the short, middle or long term.

Schedule 7 – Site plan

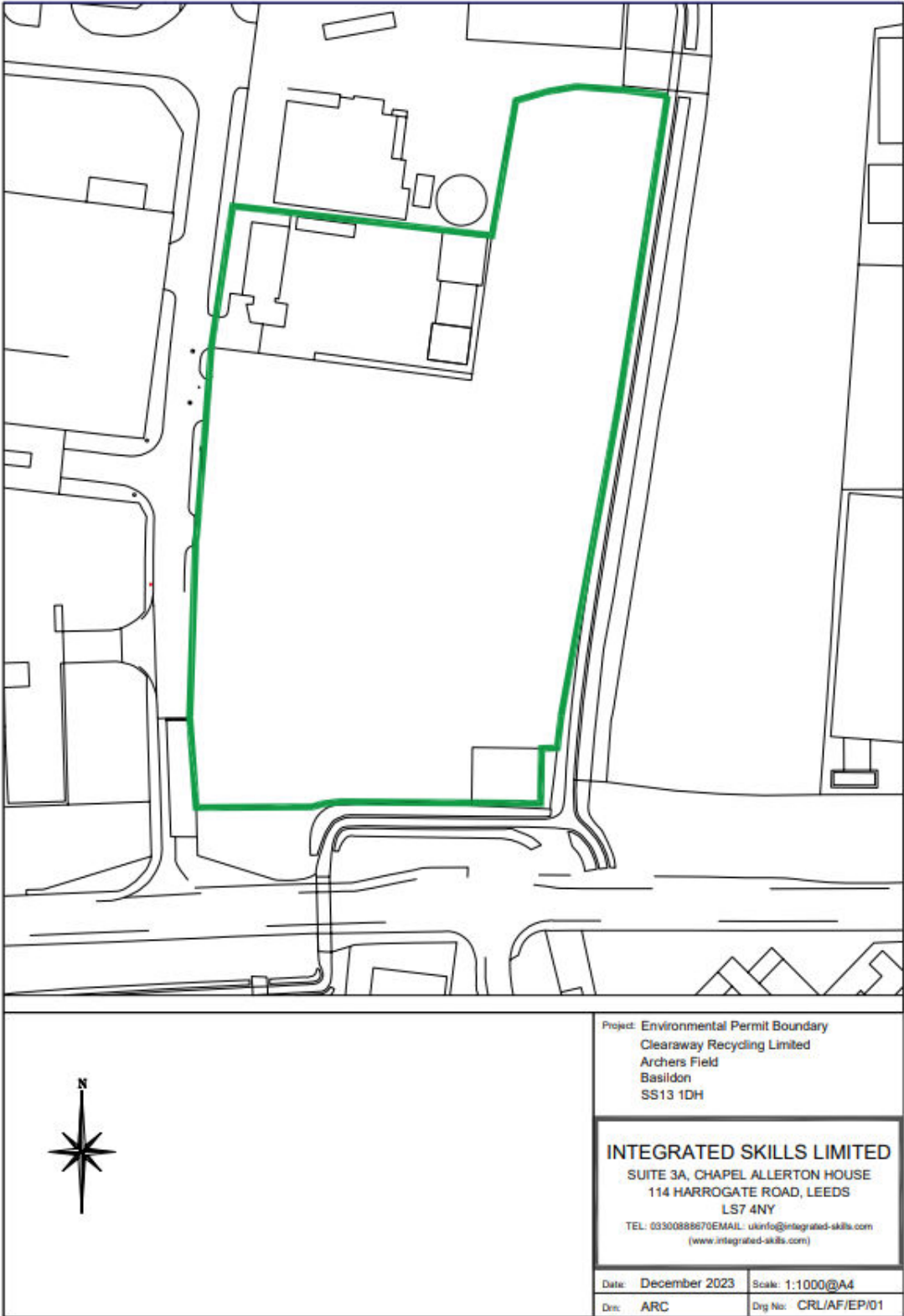

© Crown Copyright and Database Rights 2024 OS AC0000807064.

END OF PERMIT